

# High Security Pocket Door

## Specifications and Sizing

### General Information

A pocket door is a sleek, space-saving solution that adds both elegance and functionality to any room.

Unlike traditional swinging doors, pocket doors slide effortlessly into a concealed compartment within the wall, offering a clean and unobtrusive look.

For those seeking an added layer of security, we also offer a ballistic model, designed to provide superior protection without compromising on style or function. This advanced option ensures peace of mind while maintaining the elegance and space-saving benefits of a traditional pocket door.

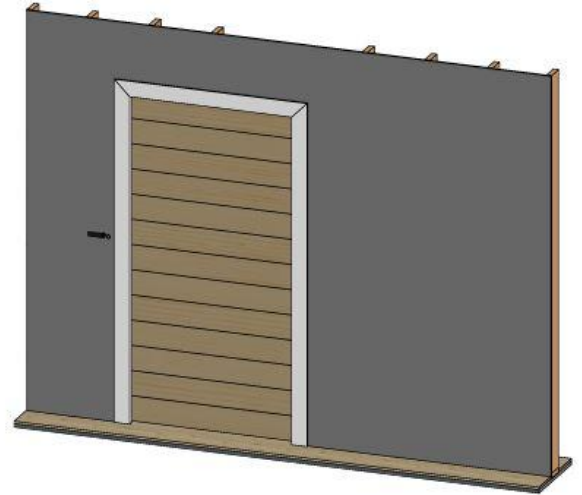

### Bullet Proofing Options

- No Ballistic Rating
- UL 3 Equivalent - (Most Handguns)
- UL 8 Equivalent- (Assault Rifles)

### Additional Customization

If you require additional customization beyond what is available on our website, please contact us for availability and a no-obligation price quote.

Phone: 480-926-1742

Email: [contact@hiddendoorstore.com](mailto:contact@hiddendoorstore.com)

### Features

- Pre-hung and tested. No wiring or assembly required.
- No complicated joinery to fit your panels. We've done all the engineering for you.
- Thresholdless design.
- Unlimited phone and video support. Expert advice and support before, during, and after installation.

# High Security Pocket Door

## Specifications and Sizing

### Wall Condition Requirements

The door must be installed in a wall opening that is plumb and level. The floor must be a hard surface, flat to within  $\frac{1}{8}$ "

### Key Dimensions

Use the charts below to determine the key dimensions of your door based on your chosen wall opening Width and Height

**Standard: 32" x 80" Clear Open**  
(80  $\frac{1}{8}$ " x 86  $\frac{7}{8}$ " Rough Opening)

### Clear Opening Dimensions

Clear Width (pass through width)	24" - 38"
Clear Height (pass through height)	80" - 96"

### Rough Opening Dimensions (RO)

RO Width	(2 x Clear Width) + 16 $\frac{1}{8}$ "
RO Height	Clear Height + 6 $\frac{7}{8}$ "

*For larger Sizes please contact the  
Hidden Door Store*

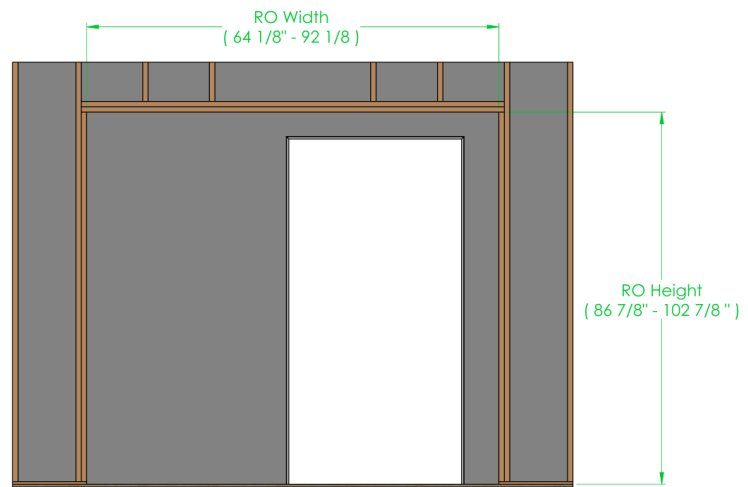
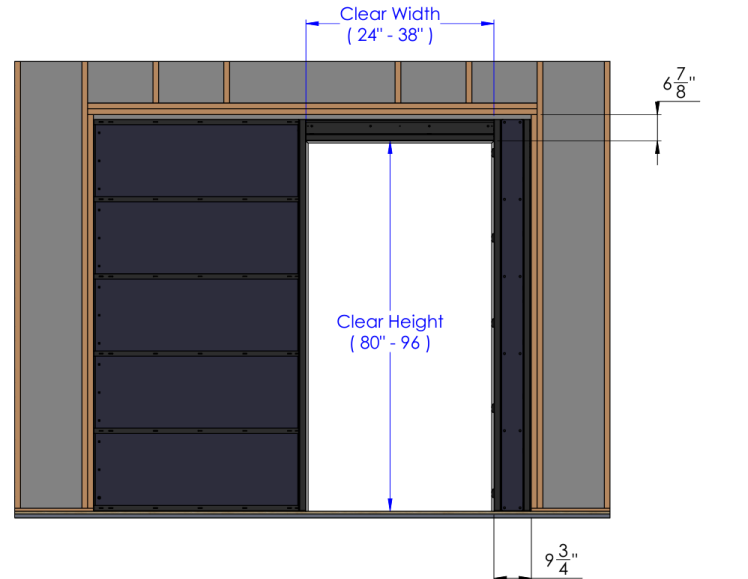

# High Security Pocket Door

## Specifications and Sizing

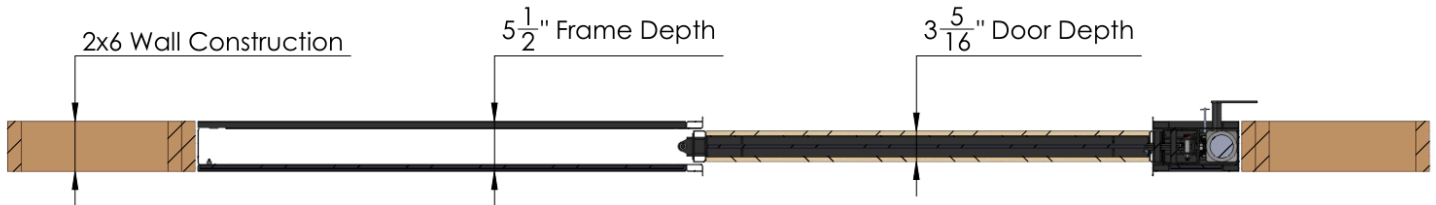

### Cladded Paneling

The Pocket door is designed to accept virtually any style of cladding so long as it does not exceed 1/2" in thickness. Drywall and Cladded Paneling applied using construction adhesive.

#### **Available Options:**

- None (Standard)
- Maple
- Alder
- Additional Options Contact the Hidden Door Store

### Access Control Options

- Remote Control
- Wireless Keypad
- Finger Print Sensor

### Electronics

Egress button is provided along with a single gang box mounted near the doorway. Control box to be located within 20 feet of the door and powered by a standard 110VAC outlet.